

# KÄRCHER

makes a difference

**BD 70/75 W Classic Bp**  
**BD 80/100 W Classic Bp**

English	3
Français	15
Español	29



**Register  
your product**

[www.kaercher.com/welcome](http://www.kaercher.com/welcome)



59688290 (09/20)



## Contents

IMPORTANT SAFETY INSTRUCTIONS .....	3
OPERATING SAFETY RULES AND PRACTICES .....	3
MAINTENANCE AND REBUILD PRACTICES .....	4
FIRE SAFETY STANDARD .....	4
General notes .....	4
Function .....	4
Intended use .....	4
Environmental protection .....	5
Accessories and spare parts.....	5
Scope of delivery .....	5
Safety instructions .....	5
Description of the unit .....	6
Installation.....	7
Initial startup .....	9
Operation .....	10
Transport.....	12
Storage .....	12
Care and service.....	12
Troubleshooting guide .....	14
Warranty .....	14
Accessories .....	14
Technical data.....	15

## IMPORTANT SAFETY INSTRUCTIONS

### READ ALL INSTRUCTIONS BEFORE USING THIS APPLIANCE

#### ⚠ WARNING

**To reduce the risk of fire, electric shock, or injury:**  
DO NOT LEAVE appliance unattended when plugged in.  
Unplug from outlet when not in use and before servicing.

#### ⚠ WARNING

**TO REDUCE THE RISK OF ELECTRIC SHOCK-USE INDOORS ONLY**

- Do not allow to be used as a toy. Close attention is necessary when used by or near children.
- Use only as described in this manual. Use only manufacturer's recommended attachments.
- Do not use with damaged cord or plug. If the unit is not working as it should, has been dropped, damaged, left outdoors, or dropped into water, return it to a service center.
- Do not pull or carry by the cord, do not use cord as a handle, do not close a door on the cord, or pull cord around sharp edges or corners. Do not run appliance over cord. Keep cord away from heated surfaces.
- DO NOT UNPLUG BY PULLING CORD. To unplug, grasp plug, not cord.
- Do not handle plug or appliance with wet hands.
- Do not put any objects into openings. Do not use if openings are blocked; keep free of dust, lint, hair, and anything that may reduce air flow.
- KEEP HAIR, CLOTHING, LOOSE JEWELRY, FINGERS and all parts of the body away from openings and moving parts.
- Turn off all controls before unplugging.
- Use extra care when cleaning on stairs.
- Do not use to pick up flammable or combustible liquids, such as gasoline, or use in areas where they may be present.
- Connect to a properly grounded outlet only. See Grounding Instructions.

- Always disconnect cord from electrical outlet before servicing appliance.
- Never sweep off explosive liquids, combustible gases or undiluted acids and solvents. This includes petrol, paint thinner or heating oil which can generate explosive fumes or mixtures upon contact with the air. Acetone, undiluted acids and solvents must also be avoided as they can harm the materials on the machine.
- Do not vacuum up burning or smouldering objects!

## GROUNDING INSTRUCTIONS

This device must be grounded. If it should malfunction or break down, grounding provides a path of least resistance for electric current to reduce the risk of electric shock.

This device is equipped with a cord having an equipment grounding conductor and ground plug.

The plug must be plugged into an appropriate outlet that is properly installed and grounded in accordance with all local codes and ordinances.

## ⚠ DANGER

**Improper connection of the equipment grounding conductor can result in a risk of electrocution.**

Check with a qualified electrician or service personnel if you are in doubt as to whether the outlet is properly grounded.

Do not modify the plug provided with the product - if it will not fit the outlet, have a proper outlet installed by a qualified electrician.

Do not use any type of adapter with this product.

This appliance is for use on a nominal 120-volt circuit and has a grounding attachment plug that looks like the plug illustrated in sketch picture A.

Make sure that the appliance is connected to an outlet having the same configuration as the plug.

No adaptor should be used with this appliance.

**CONNECT TO A PROPERLY GROUNDED OUTLET ONLY**

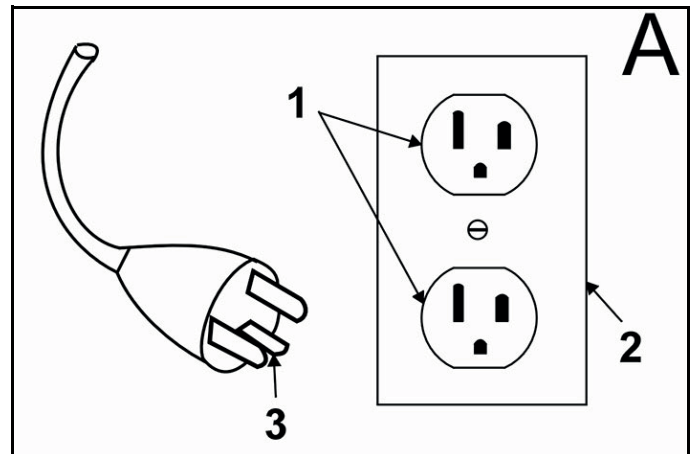

- ① Grounded outlet
- ② Grounded outlet box
- ③ Grounded pin

## OPERATING SAFETY RULES AND PRACTICES

### Owner/User Responsibility

The owner and/or user must have an understanding of the manufacturer's operating instructions and warnings before using this device.

Warning information should be emphasized and understood.

If the operator is not fluent in English, the manufacturer's instructions and warnings shall be read to and discussed with the operator in the operator's native language by the purchaser/ owner, making sure that the operator comprehends its contents.

Owner and/or user must study and maintain for future reference the manufacturers' instructions.

### General

Before starting operation, the device must be in the operating position.

Do not start or operate the device, any of its functions or attachments, from any place other than from the designated operator's position.

Before leaving the operator's position:

- 1 bring the device to a complete stop;
- 2 if the device must be on an incline, block the wheels.

Maintain a safe distance from the edge of ramps, platforms, and other similar working surfaces.

Do not add to, or modify the device.

Do not block access to fire aisles, stairways or fire equipment.

### Traveling

Yield the right of way to pedestrians and emergency vehicles such as ambulances and fire trucks.

Cross railroad tracks at an angle wherever possible. Do not park closer than 6 ft (1800 mm) to the nearest rail of a railroad track.

Keep a clear view of the path of travel and observe for other traffic, personnel, and safe clearances.

Under all travel conditions, operate the device at a speed that will permit it to be brought to a stop in a safe manner. Do not indulge in stunt driving or horseplay.

Slow down for wet and slippery floors. Before driving over a dockboard or bridge plate, be sure that it is properly secured. Drive carefully and slowly across the dockboard or bridge plate, and never exceed its rated capacity.

When negotiating turns, reduce speed to a safe level consistent with the operating environment. Make the turns smoothly.

### Operator care of the device

If the device is found to be in need of repair or in any way unsafe, or contributes to an unsafe condition, the matter shall be reported immediately to the user's designated authority, and the device shall not be operated until it has been restored to safe operating condition.

If during operation the device becomes unsafe in any way, the matter shall be reported immediately to the user's designated authority, and the device shall not be operated until it has been restored to safe operating condition.

Do not make repairs or adjustments unless specifically authorized to do so.

## MAINTENANCE AND REBUILD PRACTICES

Operation of the device may be hazardous if maintenance is neglected or repairs, rebuilds, or adjustments are not performed in accordance with the manufacturer's design criteria. Therefore, maintenance facilities (on or off premises), trained personnel, and detailed procedures shall be provided.

Maintenance and inspection of the device shall be performed in conformance with the following practices:

- 1 a scheduled planned maintenance, lubrication, and inspection system shall be followed; consult the manufacturer's recommendations.
- 2 Only trained and authorized persons shall be permitted to operate a powered floor scrubber. Operators of powered floor scrubbers shall be qualified as to visual, auditory, physical, and mental ability to operate the equipment safely.

Avoid fire hazards and have fire protection equipment present in the work area. Do not use open pans of fuel or flammable cleaning fluids for cleaning parts.

## FIRE SAFETY STANDARD

Any device not in safe operating condition shall be removed from service.

Repairs shall not be made in Class I, Class II, and Class III locations.

**Fire Prevention.** The device shall be kept in a clean condition and reasonably free of lint, excess oil, and grease. Noncombustible agents are preferred for cleaning the device. Flammable liquids [those having flash points at or above 100°F (37,8°C)] are not allowed. Precautions regarding toxicity, ventilation, and fire hazard shall be appropriate for the agent or solvent used.

**Nameplate Visibility.** The device type designations as shown on the nameplate and the type markers shall not be covered over with paint so that their identification information is obscured.

### General notes



Read these original operating instructions and the enclosed safety instructions before using the device for the first time. Proceed accordingly.

Keep both books for future reference or for future owners.

### Function

This scouring and vacuum machine is used for wet cleaning of level floors.

The device can be adjusted to suit the respective cleaning task by setting the water volume and detergent volume appropriately. The detergent dosing unit is adjusted via the amount added to the tank.

The working width and the capacity of the fresh and waste water tanks (see chapter "Technical Data") allow effective cleaning over long working times.

The device has a drive.

## Note

The device can be equipped with various accessories to suit the respective cleaning order. Request a copy of our catalog or visit our Internet website at [www.kaercher.com](http://www.kaercher.com).

### Intended use

This device is suitable for commercial and industrial use, e.g. in hotels, schools, hospitals, factories, shops, offices, and rental companies. Use the device only in accordance with the information in these operating instructions.

- The device may only be used for cleaning smooth surfaces that are insensitive to water and polishing.
- The device is not suitable for cleaning frozen floors (e.g. in cold stores).
- The device is not suitable for use in potentially explosive environments.
- The device is approved for operation on surfaces with a maximum slope (see chapter *Technical data*).

## Environmental protection



The packing materials can be recycled. Please dispose of packaging in accordance with the environmental regulations.



Electrical and electronic appliances contain valuable, recyclable materials and often components such as batteries, rechargeable batteries or oil, which - if handled or disposed of incorrectly - can pose a potential threat to human health and the environment. However, these components are required for the correct operation of the appliance. Appliances marked by this symbol are not allowed to be disposed of together with the household rubbish.

### Notes on the content materials (REACH)

Current information on content materials can be found at: [www.kaercher.de/REACH](http://www.kaercher.de/REACH)

## Accessories and spare parts

Only use original accessories and original spare parts. They ensure that the appliance will run fault-free and safely.

Information on accessories and spare parts can be found at [www.kaercher.com](http://www.kaercher.com).

## Scope of delivery

During unpacking, check the contents for completeness. If any accessories are missing or in the event of any shipping damage, please notify your dealer.

## Safety instructions

Before using the device for the first time, read and observe these operating instructions and the accompanying brochure: Safety instructions for brush cleaning units spray retraction devices, No. 5.956-251.0.

The device is approved for operation on surfaces with a specified limited slope (see Chapter *Technical data*).

## ⚠ WARNING

### Device tipping over

Danger of injury

Do not operate the device on sloping surfaces.

The device may only be operated when the hood and all covers are closed.

### Safety devices

## ⚠ CAUTION

### Missing or modified safety devices

Safety devices are provided for your own protection.

Never modify or bypass safety devices.

### Safety button

The device switches off when the safety button is released.

### Key-operated switch

Pulling the key out of the key-operated switch secures the device against unauthorized use.

### Warning symbols

Observe the following warnings when handling the batteries:



Observe notes in the instructions of the battery, on the battery and in these operating instructions.

	Wear eye protection.
	Keep acids and batteries away from children.
	Risk of explosion
	Fire, sparks, open flames and smoking are prohibited.
	Risk of acid burns
	First aid.
	Warning
	Disposal
	Do not throw batteries in the bin.

# Description of the unit

## Overview of the unit

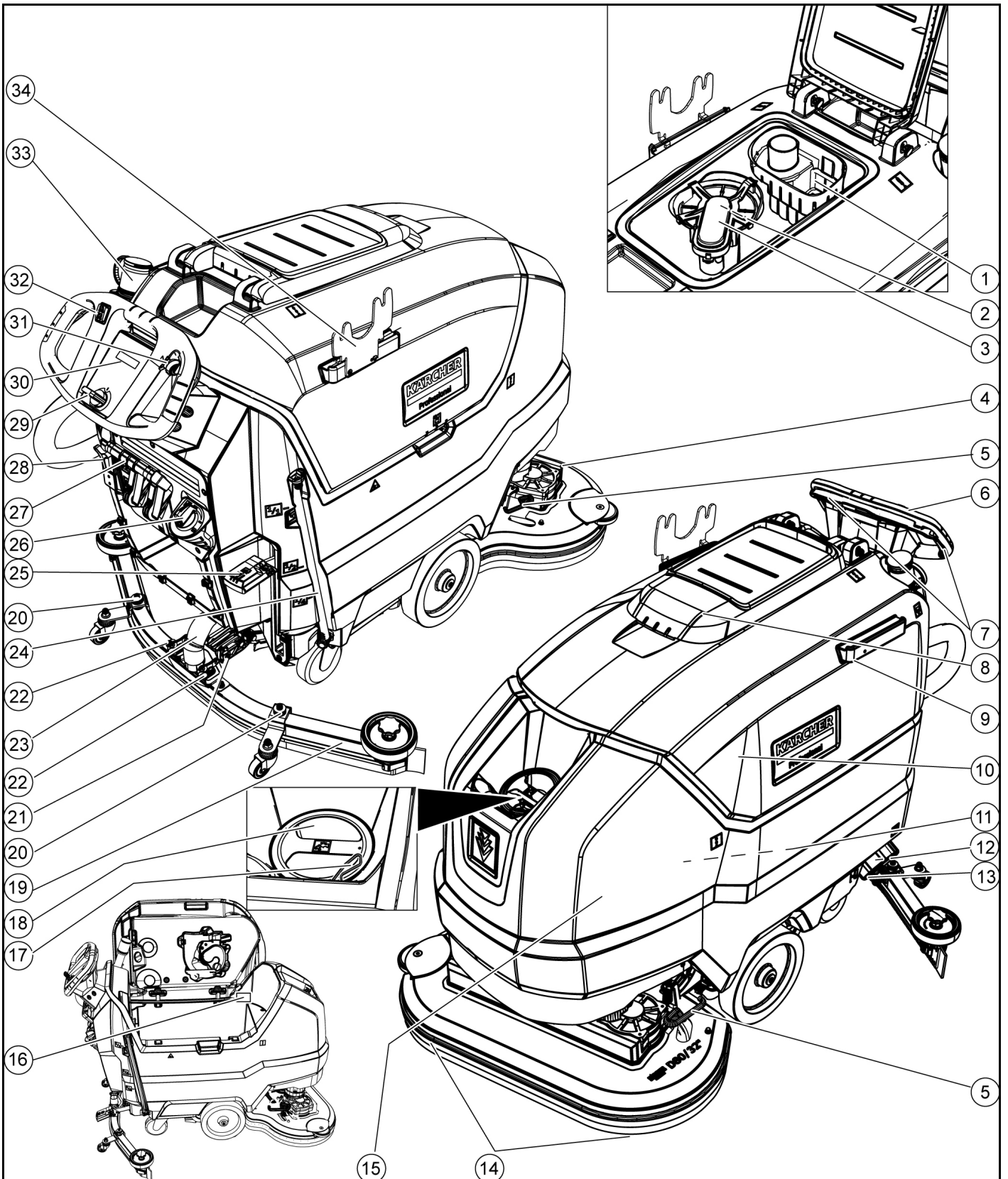

- ① Coarse dirt sieve
- ② Fluff filter
- ③ Float
- ④ Cleaning head
- ⑤ Brush replacement pedal
- ⑥ Push handle
- ⑦ Safety button
- ⑧ Waste water tank cap

- ⑨ Homebase retaining rail
- ⑩ Waste water tank
- ⑪ \*\* Battery
- ⑫ Fresh water filter
- ⑬ Fresh water tank lock
- ⑭ Disc brush
- ⑮ Fresh water tank
- ⑯ Type plate











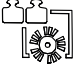

- ⑰ Hose switch
- ⑱ Fresh water tank filling hole
- ⑲ Suction bar
- ⑳ Suction bar height adjustment
- ㉑ Suction bar inclination adjustment
- ㉒ Wing nuts for fastening the suction bar
- ㉓ Suction hose
- ㉔ Fresh water filling level display  
Fresh water drain hose
- ㉕ Cleaning head lever
- ㉖ Water volume regulation knob
- ㉗ Suction bar lever
- ㉘ Battery plug connector
- ㉙ Key-operated switch
- ㉚ Display
- ㉛ Working speed rotary knob
- ㉜ Travel direction switch
- ㉝ Waste water tank drain hose with dosing unit
- ㉞ Transport holder for suction bars

\*\* Not in scope of delivery

### Color coding

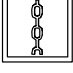
- Control elements for the cleaning process are yellow.
- Control elements for maintenance and servicing are light gray.

### Symbols on the device

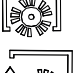
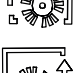
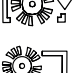
-  Fresh water tank drain opening
-  Waste water tank drain opening
-  Increased cleaning head contact pressure
-  Battery access
-  Fresh water tank filling level (50%)
-  Insert the charger plug here
-  Eyelet point
-  \* Mop holder
-  **ATTENTION**  
Incorrect socket  
Risk of damage  
DO NOT insert the charger plug here
-  Normal cleaning head contact pressure
-  Raise the cleaning head
-  Pedal for raising/lowering the cleaning head
-  Brush replacement pedal

\* optional

## Installation

### Unloading

1. Remove the carton.
  2. Remove the straps.
  3. Remove the wooden blocks fastened to the pallet by screws.
  4. Put a ramp in front of the pallet using the 3 upper reinforcement boards from the carton packaging and the safety board screwed across the pallet and fasten with particle board screws.
- ① Safety board
  - ② Squared timber
  - ③ Reinforcement board
5. Push the squared timber unscrewed from the pallet under the ramp for support and screw tight.
  6. Press the cleaning head lever downwards and engage it towards the right.
  7. **For BD 80/100 only:** Press the brake lever down.

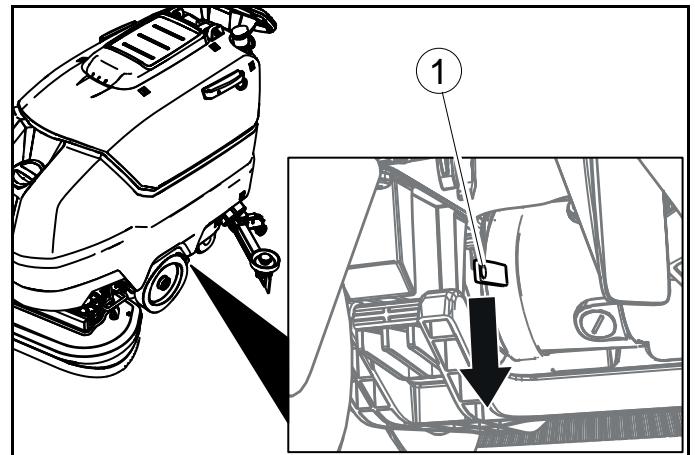

- ① Brake lever

### Note

There is no brake for BD 70/75. Releasing the brake is not necessary with this device.

8. Pull the device backwards off the pallet.
9. **For BD 80/100 only:** Press the brake lever up.

### Installing the suction bar

1. Insert the suction bar in the suction bar mount.

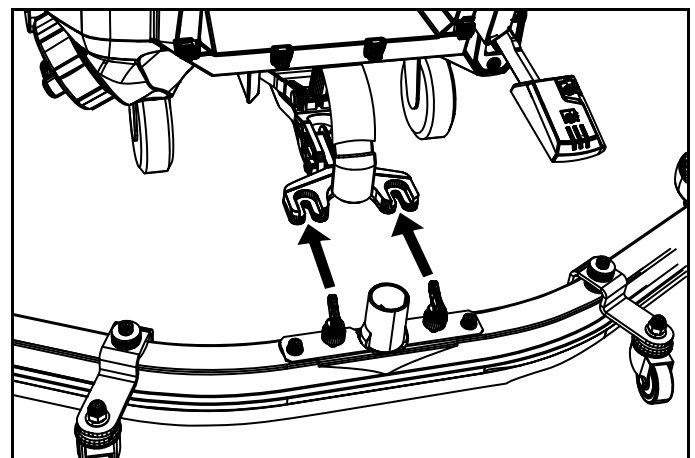

2. Tighten the wing nuts.
3. Fit the suction hose.

## Batteries

### Recommended battery sets BD 70/75

Description	Order no.	Volume (m <sup>3</sup> )*	Airflow (m <sup>3</sup> /h)**
115 Ah - maintenance-free	2.815-091.0 <sup>1)</sup>	1.98	0.792
170 Ah - maintenance-free	2.815-092.0 <sup>2)</sup>	2.31	0.924
180 Ah - maintenance-free	2.815-101.0 <sup>3)</sup>	4.785	1.914

\* Minimum volume of battery charging room

\*\* Minimum air flow between battery charging room and environment

When installing for the first time, an additional battery installation set is required:

- 1 2.638-198.0
- 2 2.638-162.0
- 3 2.638-106.0

### Recommended battery sets BD 80/100

Description	Order no.	Volume (m <sup>3</sup> )*	Airflow (m <sup>3</sup> /h)**
170 Ah - maintenance-free	2.815-092.0 <sup>1)</sup>	2.31	0.924
180 Ah - maintenance-free	2.815-101.0 <sup>2)</sup>	4.785	1.914
240 Ah - maintenance-free	2.815-102.0 <sup>2)</sup>	6.27	2.508
285 Ah - maintenance-free	2.815-095.0 <sup>3)</sup>	11.88	4.752

\* Minimum volume of battery charging room

\*\* Minimum air flow between battery charging room and environment

When installing for the first time, an additional battery installation set is required:

- 1 2.638-162.0
- 2 2.638-106.0
- 3 2.638-197.0

### Low-maintenance batteries (wet batteries)

## ⚠ DANGER

### Refilling discharged batteries with water

Danger of acid burns from escaping acid, destruction of clothes

Wear safety goggles when handling the batteries.

Observe the applicable regulations.

Immediately rinse off any splashed acid from the skin or clothes using copious amounts of water.

## ATTENTION

### Using water with additives

Defective batteries, loss of warranty claim

Top up the batteries using only distilled or desalinated water (EN 50272-T3).

Do not use any foreign additives, so-called enhancing agents, because this will invalidate the warranty.

1. Add distilled water one hour before the charging process comes to an end. Observe the correct acid level according to the battery label.  
All cells must produce gas at the end of the charging process.

### Maintenance-free batteries (AGM and gel batteries)

## ATTENTION

### Risk of damage when opening AGM and gel batteries!

AGM and gel batteries are maintenance-free and have a closed battery housing. Refilling them with distilled water or battery acid is not possible and is not necessary. Opening or drilling the battery housing will damage an AGM or gel battery and it will have to be replaced.

Do not open the battery housing and do not drill any holes. Do not cover the pressure relief valve and do not change it.

1. Only charge AGM and gel batteries using the specified chargers, see chapter: *Charging the battery.*

### Installing and connecting batteries

## ⚠ CAUTION

### Removing and installing the batteries

Unstable machine position

Ensure that the machine is positioned stably when removing and installing the batteries.

## ATTENTION

### Incorrect connection polarity

Destruction of the control electronics

Take care to ensure the correct polarity when connecting the batteries.

## ATTENTION

### Deep discharge

Risk of damage

Charge the batteries before starting the device.

1. Drain the waste water.
2. Pivot the waste water tank upwards.
3. Place the battery in the device as shown. **Important:** Push the batteries all the way back!

### BD 80/100:

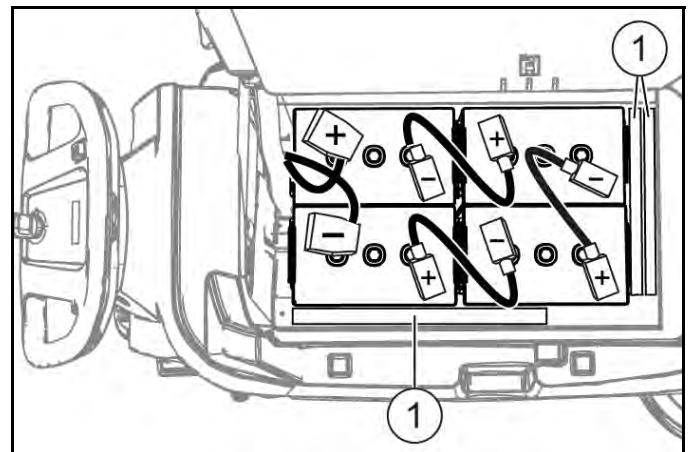

170 Ah, 2.815-092.0

180 Ah, 2.815-101.0

240 Ah, 2.815-105.0

285 Ah, 2.815-095.0

- ① Spacer



## BD 70/75:

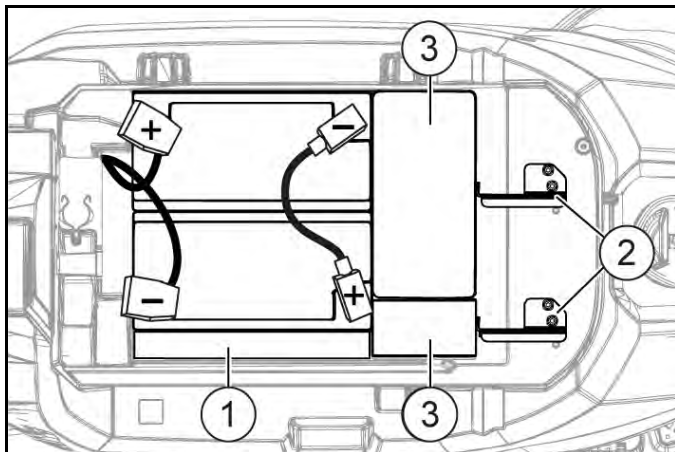

115 Ah, 2.815-091.0

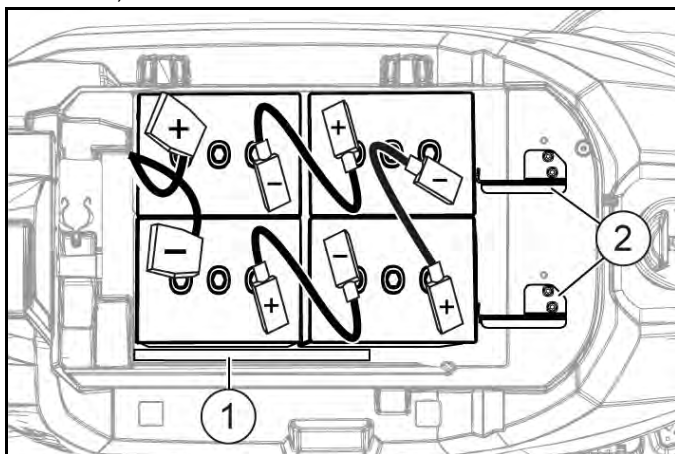

170 Ah, 2.815-092.0

180 Ah, 2.815-101.0

- ① Spacer
- ② Battery holder
- ③ Additional weights
4. Insert a spacer between the right batteries and the fresh water tank,
  - a **for 115 Ah battery pack:** 1 piece lengthwise, flat.
  - b **for battery packs other than 115 Ah:** 2 pieces lengthwise upright on top of each other.
5. **For BD 70/75 with battery pack 115 Ah:** Insert the 4 additional weights.
6. Attach the battery fastener, to do so
  - a **for BD 70/75:** Install the 2 battery holders and **for 115 Ah:** Tighten at the left and middle threaded holes. **For 170 Ah / 180 Ah:** Tighten at the right and middle threaded holes.
  - b **for BD 80/100:** Insert one or two spacers flat lengthwise or vertically between the front batteries and the fresh water tank so that the batteries cannot slip forward.
7. Connect the battery terminals using the connection cables from the battery installation kit.
8. Clamp the connecting cable on the (+) and (-) battery terminals that are still free.
9. Connect the device-side battery connector to the battery-side battery connector.
10. Pivot the waste water tank downwards.

## Removing the battery

### ⚠ CAUTION

#### Removing and installing the batteries

Unstable machine position

Ensure that the machine is positioned stably when removing and installing the batteries.

1. Turn the key-operated switch to "0" and remove the key.
2. Disconnect the battery connector.
3. Drain the waste water.
4. Pivot the waste water tank upwards.
5. Disconnect the device-end cable from the negative terminal at the battery.
6. Disconnect the remaining cables from the battery.
7. **For BD 80/100:** Remove the spacer(s) between the front batteries and the fresh water tank.
8. **For 115 Ah battery pack:** Take out the additional weights.
9. Remove the battery.
10. Dispose of the used batteries in accordance with statutory provisions.

## Initial startup

### Charging the battery

### ⚠ DANGER

#### Inappropriate use of the charger

Electric shock

Adhere to the mains voltage and fuse values specified on the device type plate.

Only use the charger in dry rooms with sufficient ventilation.

### ATTENTION

#### Accumulation of dangerous gases under the tank during the charging process

Risk of explosion

Pivot the waste water tank upwards before charging low-maintenance batteries.

### ATTENTION

#### Using an unsuitable charger

Risk of damage

Do not connect the charger to the device-side battery connector.

Use only a charger suitable for the type of battery installed. Read the operating instructions of the charger manufacturer and observe the safety instructions in particular.

Battery set	Capacity	Charger
2.815-091.0	115 Ah	6.654-367.0
2.815-092.0	170 Ah	6.654-436.0
2.815-101.0	180 Ah	6.654-434.0
2.815-105.0	240 Ah	6.654-437.0
2.815-095.0	285 Ah	6.654-419.0

The average charging time is approx. 10-15 hours.

The device cannot be used during the charging process.

### Note

The device has deep discharge protection, i.e. the brush motor and turbine are switched off automatically when the permitted minimum capacity level is reached.

1. Drive the device directly to the charger and do not drive on slopes.

2. Pull out the device-side battery connector.

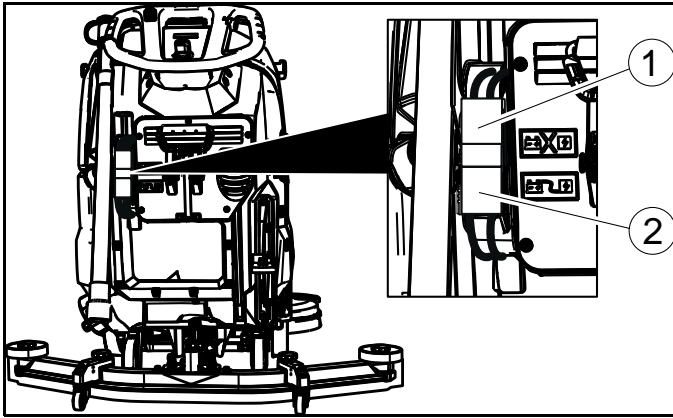

- ① Battery plug, device side
- ② Battery plug, battery side

3. Connect the battery-side battery connector to the charger.
4. Plug the mains plug of the charger into the socket.
5. Carry out the charging process in accordance with the operating instructions for the charger.
6. Connect the device-side battery connector to the battery-side battery connector.

## Operation

### ATTENTION

#### Risks during operation

Danger of injury

Release the safety button in the case of danger.

#### Filling with operating materials

##### Filling with fresh water

1. Open the fresh water tank lock.
2. Fill fresh water (max. 122 °F (50 °C)) to the lower edge of the fill-ing nozzle.  
**Note:** The fresh water hose can be clamped in the hose switch during filling.
3. Close the fresh water tank lock.

#### Notes on detergents

### ⚠ WARNING

#### Unsuitable detergents

Health risk, damage to the device

Use only recommended detergents. The operator carries all increased risks relating to operational safety and increased risk of accidents if using other detergents. Use only detergents free of solvents, salt and hydrofluoric acid.

Adhere to the safety instructions stated on the detergent packaging.

### Note

Do not use heavily foaming detergent.  
Recommended detergents

Usage	Detergent
Maintenance cleaning of all water-resistant floors	RM 746 RM 780
Maintenance cleaning of polished hard surfaces (e.g. granite)	RM 755 es
Maintenance cleaning and basic cleaning of industrial floors	RM 69 ASF

Usage	Detergent
Maintenance cleaning and basic cleaning of fine stone tiles	RM 753
Maintenance cleaning of tiles in sanitary areas	RM 751
Cleaning and disinfection in sanitary areas	RM 732
Coating removal on all alkaline-resistant floors (e.g. PVC)	RM 752
Coating removal on linoleum floors	RM 754

#### Detergent

1. Fill the detergent into the fresh water tank.

**Note:** The cap of the fresh water tank filling hole can be used for measuring the detergent. It is fitted with a scale on the inside.

#### Adjusting the water volume

1. Adjust the water volume via the regulating knob to suit the degree of contamination of the floor covering.

### Note

Perform initial cleaning tests with a low water volume. Increase the water volume step by step until achieving the desired cleaning result.

### Note

The cleaning head continues operating without a liquid supply if the fresh water tank is empty.

#### Adjusting the suction bar

##### Adjusting the inclination

The inclination must be adjusted so that the suction lips of the suction bar make even contact with the floor over the entire length of the suction bar.

1. Loosen the screw.

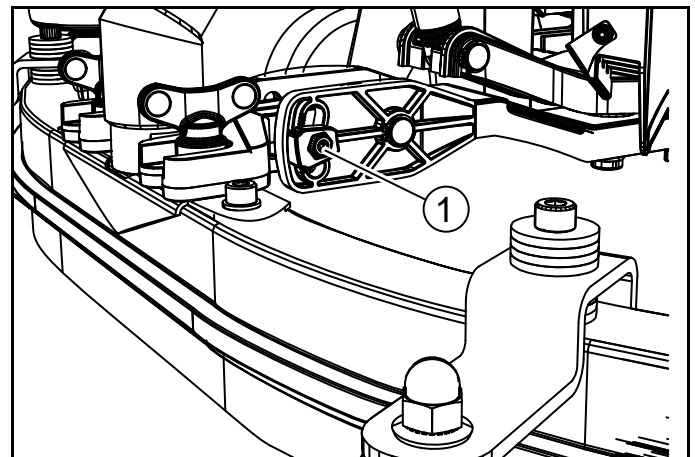

- ① Screw
2. Adjust the inclination of the suction bar.
3. Tighten the screw.

#### Adjusting the height

The height adjustment affects the bending of the suction lips on contact with the floor.

1. Push the device a small distance forwards.
2. Compare the bending of the suction lips with the illustration below.

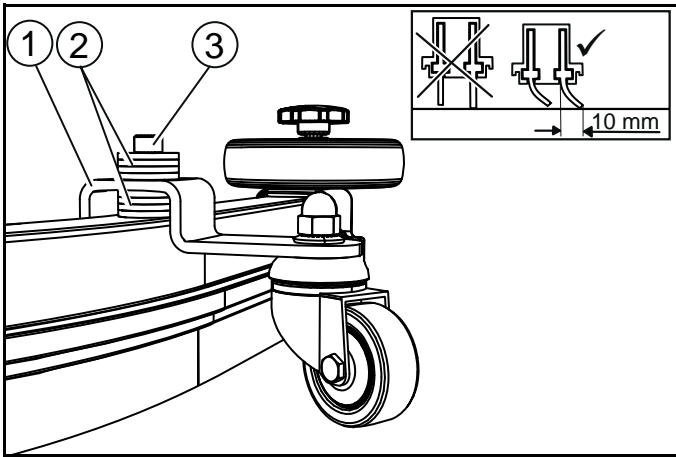

- ① Spacer roller with holder
- ② Washer
- ③ Screw

3. Unscrew the screw.
4. Position a sufficient number of washers between the suction bar and spacer roller so that the suction lips have the correct bend.
5. Fit the remaining washers above the spacer roller.
6. Screw in and tighten the screw.
7. Repeat the entire procedure at the other spacer roller.
8. Push the device a small distance forwards.
9. Check the bending of the suction lips over the entire length.
10. If necessary, repeat the entire adjustment process.

### Cleaning

#### Switching the device on

1. Turn the key-operated switch to "1".  
The display shows the following one after the other:
  - Period of time until the next after-sales Customer Service
  - Software version, control panel
  - Charging state of the battery and number of operating hours

#### Driving

### Note

The travel direction can be changed during the cleaning operation. This way, a certain position can be intensively cleaned by driving back and forth several times.

1. Set the travel direction switch to "forward".

### Note

To reduce vehicle width, the suction bar can be fastened to the transport holder. Narrow spaces can then be easily passed through.

#### Cleaning

### Note

The inclination and height of the suction bar can be adjusted to improve the vacuuming results (see chapter *Adjusting the suction bar*).

### Note

When the waste water tank is full, the float switch closes the suction opening and the suction turbine runs at a higher speed. In this case, raise the suction bar and drive to the location for emptying the waste water tank.

1. Turn the working speed rotary knob to the desired value. The speed is shown on the display during the adjustment. The display is shown in percentage of the maximum speed.
2. Set the water volume at the regulating valve.
3. Press the suction bar lever downwards. The suction bar lowers. Suctioning begins.
4. Press the cleaning head lever downwards, unlatch it and allow it to move upwards.
5. Pull the safety button towards the push handle. The cleaning head starts up and the device moves at the set speed.

#### Increasing the brush contact pressure

1. Let go of the safety button.
2. Lift the cleaning head lever up with your hand and engage it towards the right.

#### Finishing operation

##### Finishing cleaning

1. Let go of the safety button.
2. Press the cleaning head lever downwards and engage it towards the right.
3. Continue moving a short distance. The residual water is vacuumed up.
4. Lift the suction bar. The suctioning continues to run for 10 seconds afterwards.
5. Turn the key-operated switch to "0".
6. Charge the batteries if necessary.

#### Draining the waste water

### ⚠ WARNING

#### Improper disposal of waste water

Environmental pollution

Observe the local waste water treatment regulations.

1. Remove the drain hose from the support and lower it over a suitable collecting device.

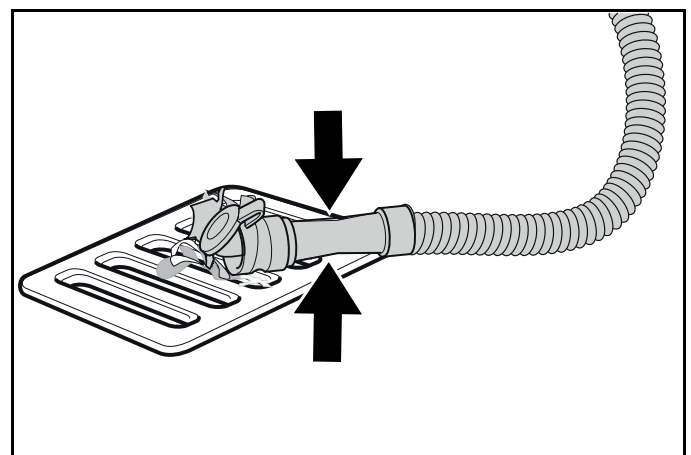

2. Press the dosing device together or kink the hose.
3. Open the dosing device cover.
4. Drain the waste water. Regulate the water volume by pressing or kinking.
5. Rinse the waste water tank with clear water.

#### Draining fresh water

1. Pull off the filling level display hose and swivel it down.

##### Draining fresh water quickly

1. Unscrew the fresh water tank lock.
2. Allow the fresh water to drain away.

- Fit the fresh water tank lock and screw into place.

**Note:** Ensure that the hose connection in the fresh water tank lock lies at the lowest point after screwing tight.

## Transport

### ⚠ DANGER

#### Driving on slopes

Danger of injury

Observe the maximum permissible inclination when driving the device on slopes for loading and unloading purposes (see chapter "Technical Data").

Drive slowly.

### ⚠ CAUTION

#### Failure to observe the weight

Risk of injury and damage

Be aware of the weight of the device during transportation. Only load the device with the assistance of another person or by using the drive.

- Press the cleaning head lever downwards and engage it towards the right.
- Raise the suction bar.
- Turn the key-operated switch to "1".
- Select the travel direction at the travel direction switch.
- Pull the safety button towards the push handle.
- When transporting in vehicles, secure the device against slipping and tipping over according to the applicable guidelines.

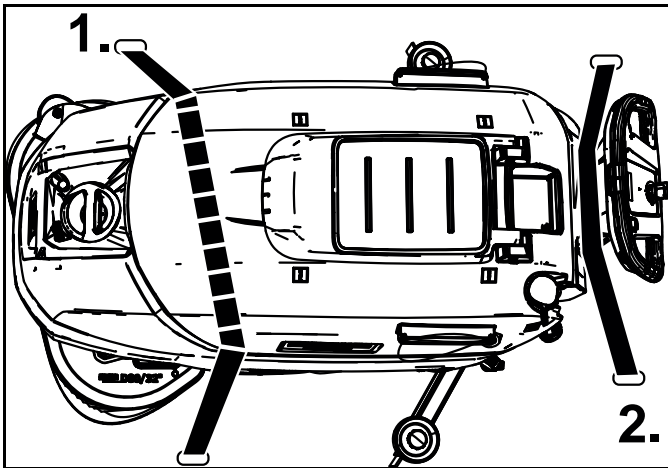

- First fit the strap under the waste water tank.

## Storage

### ⚠ CAUTION

#### Failure to observe the weight

Risk of injury and damage

Be aware of the weight of the device during storage.

### ATTENTION

#### Frost

Destruction of the device through freezing water

Drain all water from the device.

Store the device in a frost-free location.

- This device may only be stored indoors.
- Fully charge the batteries before storing them for a long period.
- Fully charge the batteries at least every month during storage.

## Care and service

### ⚠ DANGER

#### Inadvertently starting up device

Risk of injury, electric shock

Turn the key-operated switch to "0" and remove the key before performing any work on the device.

Pull out the charger mains plug.

- Drain and dispose of the waste water and fresh water.

#### Safety inspection/maintenance contract

You can agree on regular safety inspections or close a maintenance contract with your dealer. Please seek advice on this.

#### Maintenance intervals

##### Each time after use

### ATTENTION

#### Incorrect cleaning

Risk of damage.

Do not spray the device with water.

Do not use aggressive detergents.

A detailed description of the individual maintenance work is provided in Chapter *Maintenance work*.

- Drain the waste water.
- Rinse the waste water tank with clear water.
- Clean the exterior of the device using a damp cloth, wetted with a mild washing lye.
- Check the fluff filter and clean if required.
- Clean the coarse dirt sieve.
- Clean the suction lips, check for wear and tear and re-adjust or replace if necessary.
- Check the disc brushes for wear and tear and replace if necessary.
- Charge the battery.
  - If the charging state of the battery is below 50%, charge the battery fully and without interruption.
  - If the charging state of the battery is above 50%, only recharge the battery if the entire operating duration will be required when next used.

#### Weekly

- When used regularly, charge the battery fully and without interruption at least once a week.

#### Monthly

A detailed description of the individual maintenance work is provided in Chapter *Maintenance work*.

- Drain the fresh water tank and flush out deposits.
- Clean the fresh water filter.
- Clean the float and fluff filter.
- Check battery poles for oxidation, brush off if necessary. Make sure the connection cables are firmly in place.
- Clean the seals between the waste water tank and the cover, check for leaks and replace if necessary.
- Check the acid density of the cells if the batteries are not maintenance-free.
- For a longer downtime, shut down the device when the battery is fully charged. Fully charge the battery at least once a month.

#### Annually

- Have the prescribed inspection performed by Customer Service.



## Maintenance work

### Turn over or replace the worn suction lips

The suction lips must be turned over or replaced when they have worn down to the wear mark.

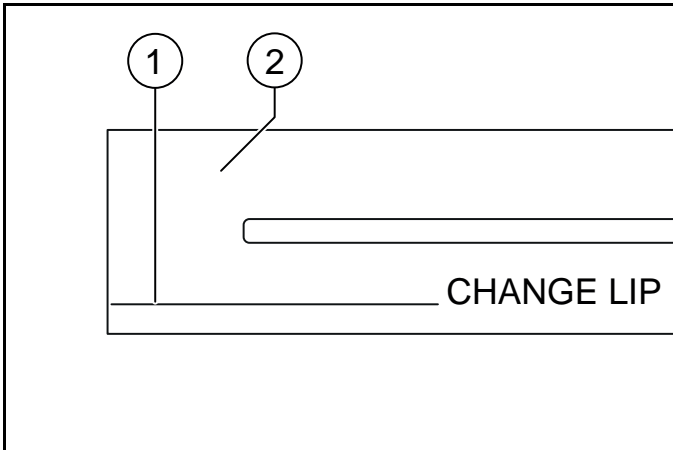

① Wear mark

② Suction lip

1. Remove the suction bar.
2. Unscrew the star handles.

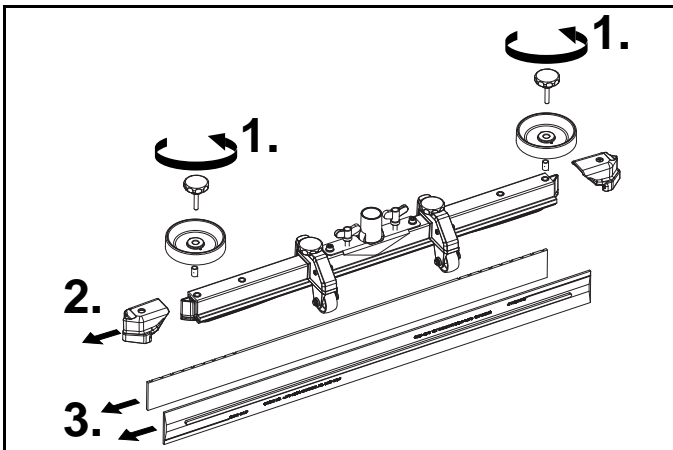

3. Pull off the plastic parts.

4. Pull off the suction lips.

5. Push in the turned over or new suction lips.

6. Push on the plastic parts.

7. Screw in and tighten the star handles.

### Cleaning the coarse dirt sieve

1. Open the waste water tank cover.

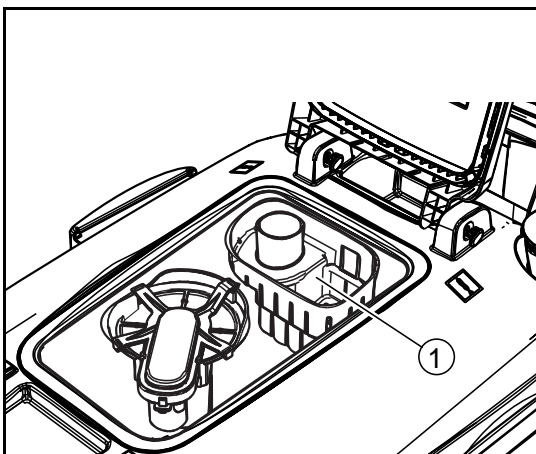

① Coarse dirt sieve

2. Pull the coarse dirt sieve upwards and off.

3. Rinse off the coarse dirt sieve under running water.

4. Reinsert the coarse dirt sieve into the waste water tank.

## Cleaning the fresh water filter

1. Drain the fresh water (see Chapter *Draining fresh water*).
2. Unscrew the fresh water tank lock.

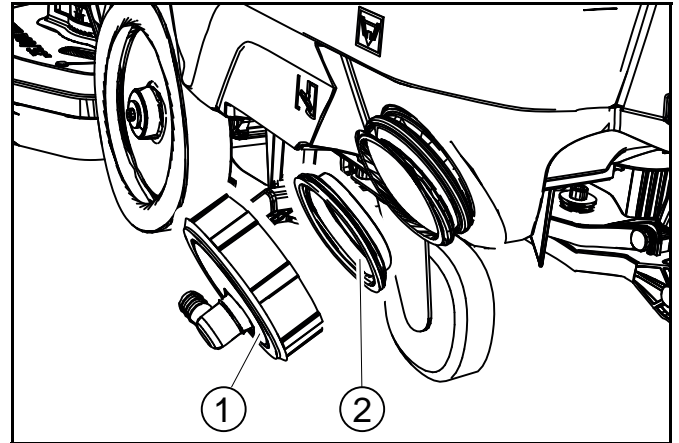

① Fresh water tank lock

② Fresh water filter

3. Pull out the fresh water filter and rinse with clean water.

4. Insert the fresh water filter.

5. Fit the fresh water tank lock.

**Note:** Ensure that the hose connection in the fresh water tank lock lies at the lowest point after screwing tight.

### Clean the float and fluff filter

1. Open the waste water tank cover.

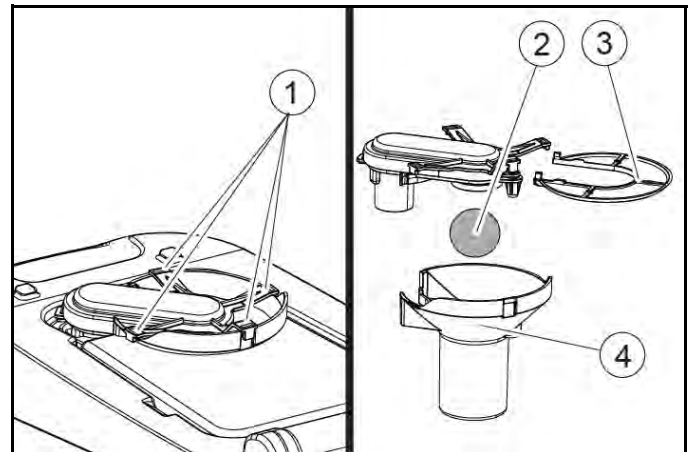

① Latching hooks

② Float

③ Fluff filter

④ Float housing

2. Release the latching hooks.

3. Pull the float housing downwards and off.

4. Remove the float from the float housing and clean it.

5. Remove the fluff filter and clean it.

6. Assemble all parts in the reverse order.

### Replacing the disc brushes

1. Raise the cleaning head.
2. Press the brush replacement pedal down, beyond the zone of resistance.
3. Pull the 1st disc brush sideways and out from underneath the cleaning head.
4. Hold the new disc brush under the cleaning head, then press upwards and latch it into position.
5. Repeat the procedure for the 2nd disc brush.

## Troubleshooting guide

### **⚠ DANGER**

#### **Inadvertently starting up device**

Risk of injury, electric shock

Turn the key-operated switch to "0" and remove the key before performing any work on the device.

Pull out the charger mains plug.

- Drain and dispose of the waste water and fresh water.
- Contact Customer Service in the case of malfunctions that cannot be corrected using this table.

Malfunction	Rectification
<b>The device cannot be started</b>	<ol style="list-style-type: none"> <li>1. Turn the key-operated switch to "1".</li> <li>2. Actuate the safety button.</li> <li>3. Insert the battery plug.</li> <li>4. Check the battery and charge if necessary.</li> <li>5. Check that the battery terminals are correctly connected.</li> </ol>
<b>The water volume is insufficient</b>	<ol style="list-style-type: none"> <li>1. Check the fresh water filling level and fill the tank if necessary.</li> <li>2. Increase the water volume at the water volume regulating knob.</li> <li>3. Clean the fresh water filter.</li> <li>4. Check the hoses for clogging and clean if necessary.</li> </ol>
<b>The suction performance is too low</b>	<ol style="list-style-type: none"> <li>1. Shut down the device and drain the waste water.</li> <li>2. Clean the seals between the waste water tank and the cover, check for leaks and replace if necessary.</li> <li>3. Check that the suction hose is correctly connected to the waste water tank.</li> <li>4. Check the fluff filter for contamination and clean if necessary.</li> <li>5. Clean the suction lips at the suction bar, turn over or replace if necessary.</li> <li>6. Check that the cap on the waste water drain hose is closed.</li> <li>7. Check the adjustment of the suction bar.</li> <li>8. Check the suction hose for clogging and clean if necessary. When fitting the suction hose again, the white marking on the hose must lie at the retaining clip.</li> <li>9. Check the suction hose for leaks and replace if necessary.</li> </ol>
<b>The cleaning results are unsatisfactory</b>	<ol style="list-style-type: none"> <li>1. Reduce the driving speed.</li> <li>2. Check the brushes for wear and tear and replace if necessary.</li> <li>3. Check the suitability of the brush type and detergent used.</li> </ol>
<b>The suction turbine runs at an increased speed</b>	<ol style="list-style-type: none"> <li>1. Drain the waste water.</li> <li>2. Clean the float.</li> <li>3. Check the fluff filter and clean if necessary.</li> <li>4. Check the suction hose for clogging and clean if necessary.</li> <li>5. Check the suction bar for clogging and remove any clogging if necessary</li> </ol>
<b>The brushes do not rotate</b>	<ol style="list-style-type: none"> <li>1. Check if the brushes are blocked by a foreign body and remove the foreign body if necessary.</li> </ol>
<b>The device vibrates during cleaning</b>	<ol style="list-style-type: none"> <li>1. Use a softer brush.</li> </ol>

### Warranty

The warranty conditions issued by our relevant sales company apply in all countries. We shall remedy possible malfunctions on your appliance within the warranty period free of cost, provided that a material or manufacturing flaw is

the cause. In a warranty case, please contact your dealer (with the purchase receipt) or the next authorized customer service site.

(See overleaf for the address)

### Accessories

Description	BD 70/75 part no.	BD 80/100 part no.	Description
Disc brush, white (soft)	4.905-011.0	4.905-030.0	For cleaning lightly contaminated or sensitive floors
Disc brush, natural color (soft)	4.905-012.0	4.905-031.0	Made of natural fibers for cleaning and polishing
Disc brush, red (medium, standard)	4.905-010.0	4.905-000.0	For use in all common cleaning orders
Disc brush, black (hard)	4.905-013.0	4.905-032.0	For heavy contamination and basic cleaning, only for non-sensitive surfaces
Pad drive board	4.762-590.0	4.762-447.0	For cleaning with pads, with quick-change coupling and center-lock
Pad, white	–	6.371-331.0	For polishing floors
Pad, red (medium soft)	6.369-003.0	6.371-147.0	For cleaning all floors



Description	BD 70/75 part no.	BD 80/100 part no.	Description
Pad, green (medium hard)	6.369-002.0	6.371-148.0	For cleaning heavily contaminated floors and for basic cleaning
Pad, black (hard)	6.369-001.0	6.371-169.0	For stubborn soiling and for basic cleaning
Pad, brown (SPP)	2.639-290.0	2.639-288.0	For protective film application on hard and elastic surfaces
Pad, melamine	6.371-021.0	6.371-336.0	For effective cleaning of micro-porous surfaces
Suction bar, 1030 mm, curved	4.777-108.0	–	
Suction bar, 1160 mm, curved	–	4.777-102.0	
Suction lip set, natural rubber	4.037-144.0	4.037-138.0	
Suction lip set, PU (oil resistant)	4.037-145.0	4.037-140.0	
Suction lip set, Linatex	4.181-011.0	4.181-006.0	

### Technical data

		BD 70/75 W Classic	BD 80/100 W Classic
<b>Device performance data</b>			
Nominal voltage	V	24	24
Battery capacity	Ah	115 / 170 / 180	170 / 180 / 240 / 285
Mean power input	W	1270	1320
Engine power	W	250	300
Suction turbine power	W	500	500
Brush drive power	W	2 x 500	2 x 500
Theoretical surface performance	ft <sup>2</sup> /h (m <sup>2</sup> /h)	37600 (3500)	43000 (4000)
Fresh water tank volume	gal (l)	19.8 (75)	26.4 (100)
Waste water tank volume	gal (l)	19.8 (75)	26.4 (100)
Water temperature max.	°F (°C)	122 (50)	122 (50)
Water pressure max.	psi (bar)	0.87 (0.06)	0.87 (0.06)
Aisle turn width	in (mm)	61 (1550)	65 (1650)
Max. working area slope	%	2	2
<b>Suctioning</b>			
Suction performance, air quantity	CFM (l/s)	50.8 (24)	50.8 (24)
Suction performance, depression	psi (kPa)	2.3 (16)	2.3 (16)
<b>Cleaning brushes</b>			
Working width	in (mm)	27.5 (700)	31.5 (800)
Brush diameter	in (mm)	14.1 (359)	16.2 (410)
Brush speed	1/min	140	140
Brush contact pressure	lbf (N)	67 / 150 (300 / 680)	90 / 200 (400 / 900)
<b>Dimensions and weights</b>			
Approved total weight	lbs (kg)	717 (325)	959 (435)
Net weight (transport weight)	lbs (kg)	553 (251)	716 (325)

		BD 70/75 W Classic	BD 80/100 W Classic
Battery compartment dimensions	in (mm)	22.6 x 14.9 (575 x 380)	24.5 x 15.1 (622 x 384)

### Determined values in acc. with EN 60335-2-72

Overall vibration value	m/s <sup>2</sup>	<2.5	<2.5
Uncertainty K	dB(A)	0.2	0.2
Sound pressure level L <sub>pA</sub>	dB(A)	65	65
Uncertainty K <sub>pA</sub>	dB(A)	2	2
Sound power level L <sub>WA</sub> + K uncertainty <sub>WA</sub>	dB(A)	81	81

Subject to technical changes without notice.

### Contenu

CONSIGNES DE SÉCURITÉ IMPORTANTES.....	15
REGLES DE SECURITE ET PRATIQUES RELATIVES A L'UTILISATION.....	16
PROCEDURES D'ENTRETIEN ET DE REMISE EN ETAT.....	17
NORMES DE SECURITE INCENDIE.....	17
Remarques générales.....	17
Fonctionnement.....	17
Utilisation conforme.....	18
Protection de l'environnement.....	18
Accessoires et pièces de rechange.....	18
Étendue de livraison.....	18
Consignes de sécurité.....	18
Description de l'appareil.....	19
Montage.....	20
Mise en service.....	22
Fonctionnement.....	23
Transport.....	25
Stockage.....	25
Entretien et maintenance.....	25
Dépannage en cas de défaut.....	27
Garantie.....	27
Accessoires.....	28
Caractéristiques techniques.....	28

**CONSIGNES DE SÉCURITÉ IMPORTANTES**  
**LIRE TOUTES LES INSTRUCTIONS AVANT D'UTILISER CET APPAREIL**



**THANK YOU!**  
**MERCI! DANKE! ¡GRACIAS!**



Registrieren Sie Ihr Produkt und profitieren Sie von vielen Vorteilen.

Register your product and benefit from many advantages.

Enregistrez votre produit et bénéficiez de nombreux avantages.

Registre su producto y aproveche de muchas ventajas.

**[www.kaercher.com/welcome](http://www.kaercher.com/welcome)**



Bewerten Sie Ihr Produkt und sagen Sie uns Ihre Meinung.

Rate your product and tell us your opinion.

Évaluer votre produit et dites-nous votre opinion.

Reseñe su producto y díganos su opinión.

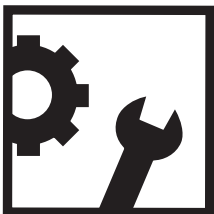

**[www.kaercher.com/dealersearch](http://www.kaercher.com/dealersearch)**

**Alfred Kärcher SE & Co. KG**  
Alfred-Kärcher-Str. 28-40  
71364 Winnenden (Germany)  
Tel.: +49 7195 14-0  
Fax: +49 7195 14-2212

